

Designed for Cycle, Standby and Solar Applications!



GENERAL FEATURES

- **GEL Technology** - The success of DG batteries comes from the internationally superior Gel technology. It is ideal for standby or frequent cyclic discharge applications under extreme environments
- **Front Access Connection** - Front access connection for fast, easy installation and maintenance with standard width for 19' and 23' ETSI racks.
- **Long Service Life** - Especially designed for telecommunication use with 10+ years design life in float service. By combining the newly developed paste formula with up-to-date GEL structures, this range features 12 years design life.
- **Maintenance-Free, Non-Spillable** - Proven VRLA technology guarantees safe operation without maintenance and 'non-restricted article' status for transportation.
- **Designed-In Reliability** - Cutting-edge manufacturing and process control combined with meticulous quality assurance procedures guarantee consistent and dependable performance

PERFORMANCE SPECIFICATIONS

Nominal Voltage	12V(6 cells)	
Design Floating Life @25°C	12 Years	
Nominal Capacity @25°C	20 hour rate	150.0Ah
	7.5A to 10.50V	
	10 hour rate	130.0Ah
	13.0A to 10.50V	
Nominal Capacity @25°C	5 hour rate	113.5Ah
	22.7A to 10.50V	
	3 hour rate	102.3Ah
	34.1A to 9.60V	
Nominal Capacity @25°C	1 hour rate	81.9Ah
	81.9A to 9.60V	
Internal Resistance	Full Charged Battery@25°C	<6.0mΩ
Energy Density (20-hr. rate)	100.56W-h/l	
Specific Energy (20-hr. rate)	41.38W-h/kg	
Shelf Life (nominal capacity at 20°C)	1 Month	97%
	3 Months	91%
	6 Months	83%
Max Short-Duration Discharge Current	5 Sec	1500A
Standby Use Charge (Constant Voltage) @25°C	Initial Charging Current Less than 30A Voltage 13.6 - 13.8V	
Cycle Use Charge (Constant Voltage) @25°C	Initial Charging Current Less than 31A Voltage 14.4 - 14.9V	
Operating Temperature Range	Charge	-20°C to 50°C
	Discharge	-40°C to 60°C

GENERAL FEATURES mm

Unit: mm

Length	565±1	Total Height	288±1
Width	110±1	Weight(kg)	43.0±1
Height	288±1		

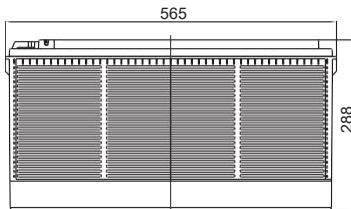
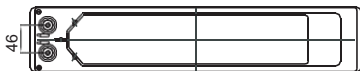

TERMINALS mm

F9 Terminal

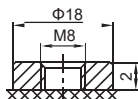

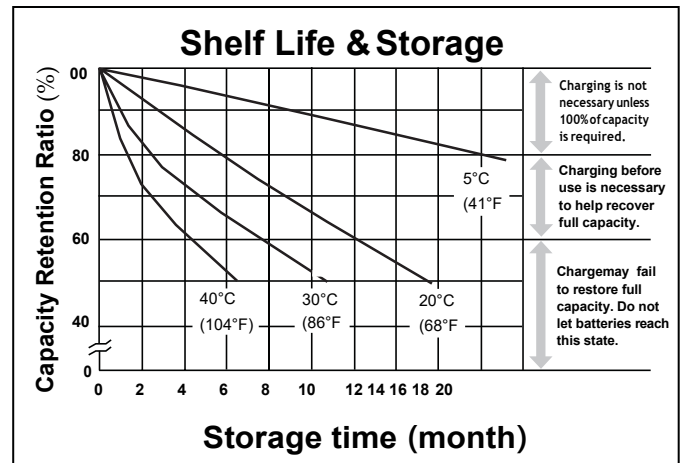
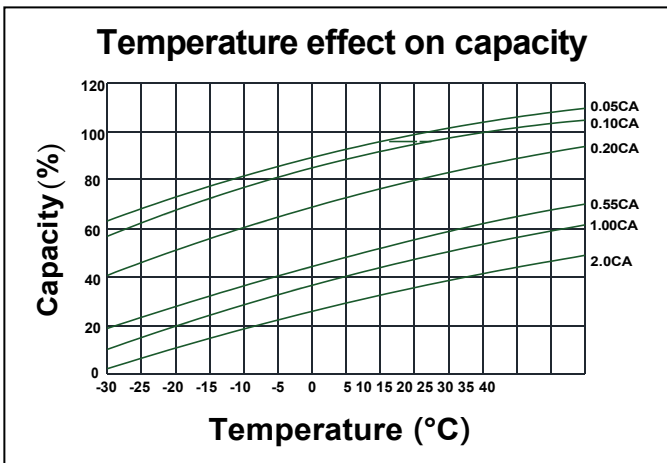
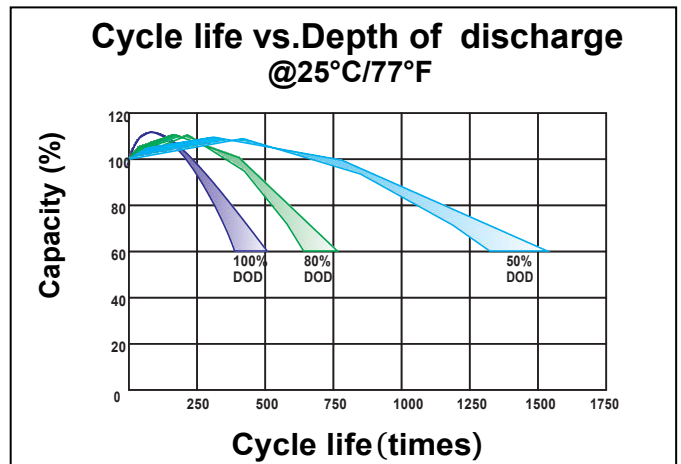
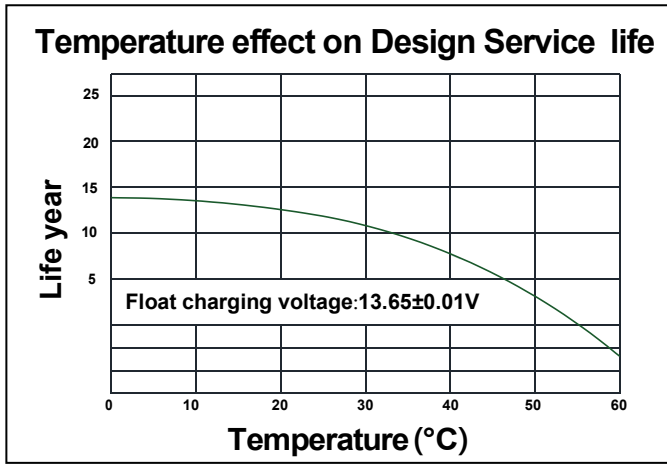
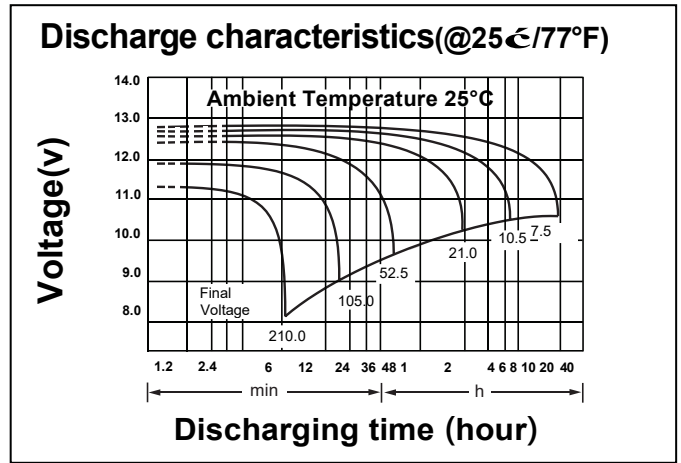
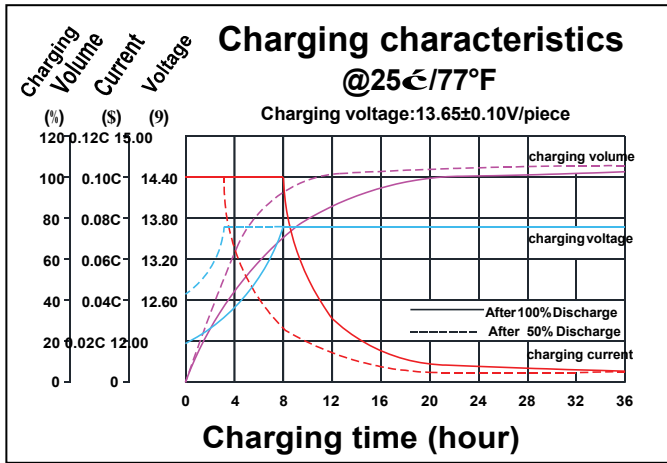

CONSTANT CURRENT DISCHARGE RATINGS (Amperes at 25°C)

F.V./Time	15MIN	30MIN	1HR	2HR	3HR	4HR	5HR	8HR	10HR	20HR
1.60V	205.2	137.5	83.8	50.2	34.7	28.4	23.3	16.0	13.5	8.25
1.65V	201.0	136.4	83.5	49.8	34.5	28.3	23.1	15.9	13.4	7.95
1.70V	197.9	135.5	82.7	49.4	34.3	28.2	23.0	15.8	13.3	7.73
1.75V	190.6	133.4	81.0	48.0	34.1	27.9	22.7	15.6	13.2	7.50
1.80V	177.7	128.8	80.0	48.2	33.2	27.2	22.3	15.4	13.0	7.05
1.85V	161.3	121.8	76.0	46.0	31.8	25.9	21.3	14.7	12.6	6.75